

Philips Fetal Scalp Electrode Application Tips

Component Set Up:

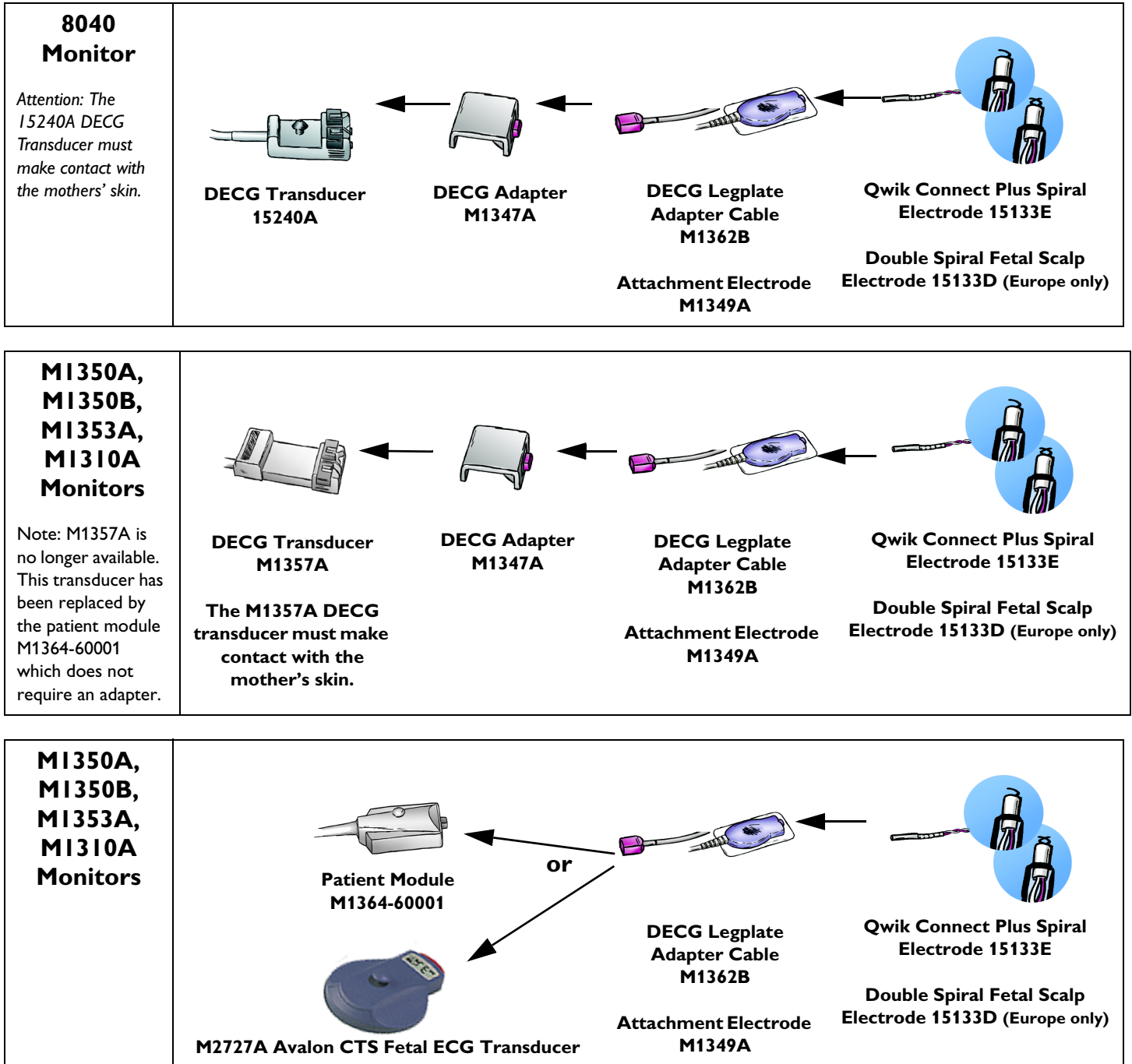

Attention:

- Check the condition of your DECG transducer 15240A or M1357A.
 - For the electrical connection to function properly, the springs in the spring clips at the side of the transducer must be working properly. You can test this by pressing in the transducer spring clips. If they spring back firmly when you release them, then the springs are strong enough to hold the electrical contact. You must also visually check the electrical contacts and make sure that they are clean and free from signs of corrosion. Replace the transducer if damaged in any way.
- Replace the reusable DECG legplate cable as needed.
- First attach the M1349A attachment electrode to the legplate adapter cable. Then apply to the patient's thigh.
- The Fetal Scalp Electrode guide tube can be bent and reshaped, if desired, while still in sterile pouch.
- Use only M1349A attachment electrode to secure the M1362B. Standard ECG electrode tabs may damage the DECG Legplate Adapter Cable end.
- Read and follow package instructions **prior** to inserting the Fetal Scalp Electrode.

Application Hints:

**DECG Transducer
15240A**

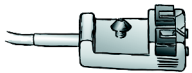

**DECG Transducer
M1357A**

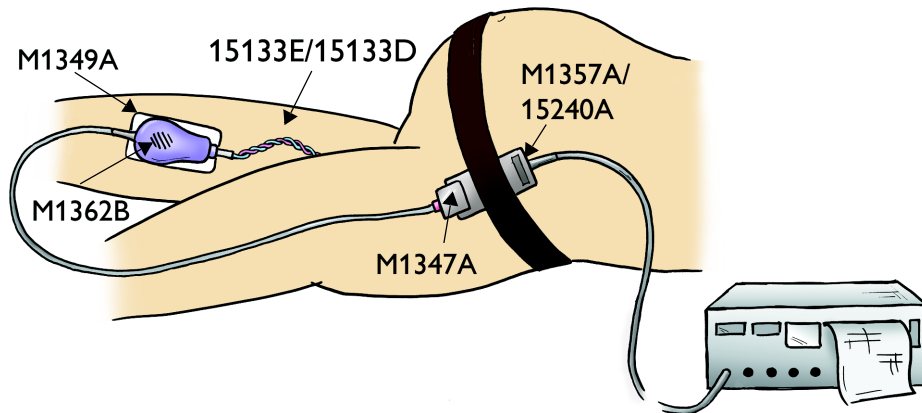

Important: Silver plate of DECG transducers (M1357A or 15240A) requires contact with mother's skin. Secure the transducer under abdominal or leg belt.

**Patient Module
M1364-60001**

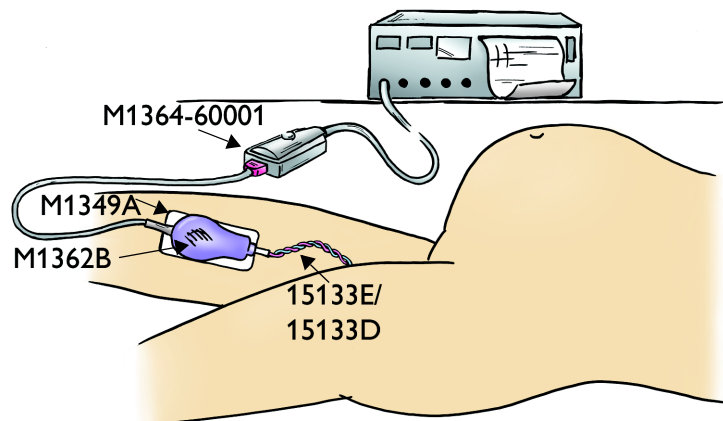
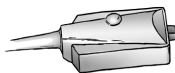

Note: Patient Module M1364-60001 does not require contact to the mother and can be secured anywhere.

Avalon CTS Cordless Fetal Transducer System

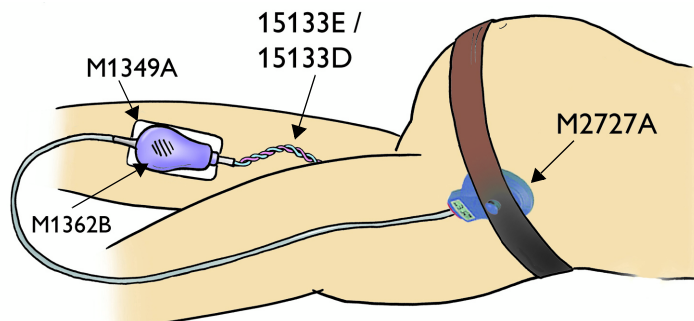

Note: Cordless ECG Transducer M2727A does not require contact to the mother and can be secured anywhere.